

Data sheet

Support roller NATV 5 (crowned, with axial guidance, full needle)

Designation	NATV 5
Type	crowned
D [mm]	16
d [mm]	5
d1 [mm max.]	12
B1 [mm]	12
B [mm]	11
r [mm]	0,15
Dynamic load Crw[N]	4850
Static load C0rw[N]	6500
Speed limit [min-1]	8500
Speed limit [min-1]	20000

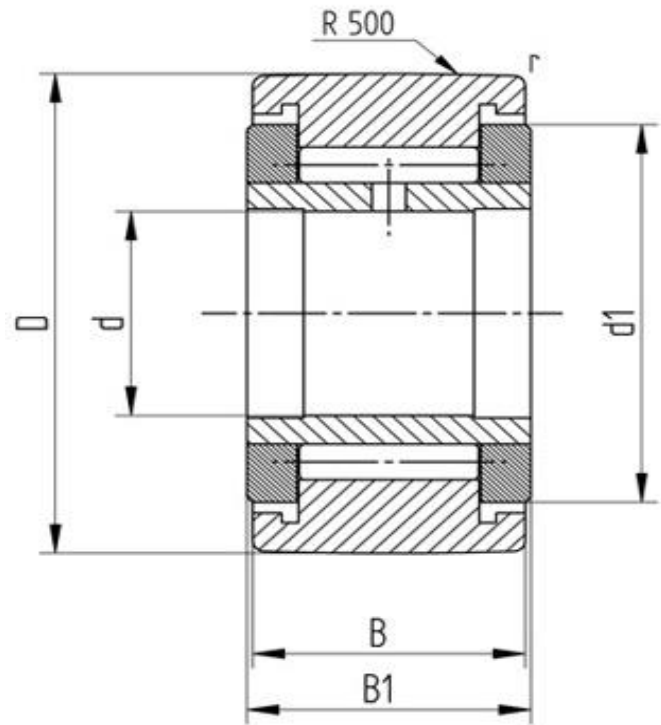

Every specification has been edited and verified carefully. STI Bearings GmbH assumes no liability for potential errors or incompleteness. Technical modifications are subject of changes.
 © 2020 by STI Bearings GmbH
 Reproduction, even excerpts, only with our approval.